

LAGAN L

en

cn



Design and Quality
IKEA of Sweden



Please refer to www.IKEA.com and select your local store for local store phone numbers and opening times.



请访问 www.IKEA.com 并选择您所在的本地商店，以获取当地商店的联系电话和营业时间。

ENGLISH
中文

5
20

Contents

Safety information.....	5	Daily use.....	12
Safety instructions.....	6	Cleaning and maintenance.....	12
Installation.....	8	Troubleshooting.....	13
First use.....	9	Technical information.....	15
Product description.....	9	Food contact list.....	16
Operation.....	10	Environmental impact list.....	17
Refrigerator compartment.....	11	Environmental requirements.....	17
Freezer compartment.....	11	IKEA Guarantee.....	18

Safety information

Before the installation and use of the appliance, carefully read the supplied instructions. The manufacturer is not responsible if an incorrect installation or use causes injuries or damages. Always keep the instructions with the appliance for future reference.

Children and vulnerable people safety



WARNING: Risk of fire /
Flammable materials

- This appliance is not intended for use by persons (including children) with reduced physical, sensory or mental capabilities, or lack of experience and knowledge, unless they have been given supervision or instruction concerning use of the appliance by a person responsible for their safety.
- Children should be supervised to ensure that they do not play with the appliance.
- Keep all packaging away from children and dispose of it appropriately.

General Safety

- This appliance is intended to be used in household and similar applications such as:
 - staff kitchen areas in shops, offices and other working environments;
 - farm houses and by clients in hotels, motels and other residential type environments;

- bed and breakfast type environments;
- catering and similar non-retail applications.
- **WARNING:** Keep ventilation openings, in the appliance enclosure or in the built-in structure, clear of obstruction.
- **WARNING:** Do not use mechanical devices or other means to accelerate the defrosting process, other than those recommended by the manufacturer.
- **WARNING:** Do not damage the refrigerant circuit.
- **WARNING:** Do not use electrical appliances inside the food storage compartments of the appliance, unless they are of the type recommended by the manufacturer.
- **WARNING:** Do not use water spray and steam to clean the appliance.
- **WARNING:** Clean the appliance with a moist soft cloth. Only use neutral detergents. Do not use abrasive products, abrasive cleaning pads, solvents or metal objects.
- **WARNING:** Do not store explosive substances such as aerosol cans with a flammable propellant in this appliance.
- **WARNING:** If the supply cord is damaged, it must be replaced by the manufacturer, its service agent or similarly qualified persons in order to avoid a hazard.
- **WARNING:** When positioning the appliance, ensure the supply cord is not trapped or damaged.

- **WARNING:** Do not locate multiple portable socket-outlets or portable power supplies at the rear of the appliance.
- Opening the door for long periods can cause a significant increase of the temperature in the compartments of the appliance.
- Clean regularly surfaces that can come in contact with food and accessible drainage systems.
- Clean water tanks if they have not been used for 48 hours; flush the water system connected to a water supply if water has not been drawn for 5 days.
- Store raw meat and fish in suitable containers in the refrigerator, so that it is not in contact with or drip onto other food.
- If the refrigerating appliance is left empty for long periods, switch off, defrost, clean, dry, and leave the door open to prevent mould developing within the appliance.
- This refrigerating appliance is not intended to be used as a built-in appliance.
- Two-star frozen-food compartments are suitable for storing pre-frozen food, storing or making ice-cream and making ice cubes.
- One-, two- and three-star compartments are not suitable for the freezing of fresh food.
- **WARNING:** To avoid a hazard due to instability of the appliance, it must be fixed in accordance with the instructions.

Safety instructions

Installation

- ⚠ **WARNING!** Only a qualified person can install this appliance.
- Remove all the packaging.
- Do not install or use a damaged appliance.
- Follow the installation instructions supplied with the appliance.
- Always take care when moving the appliance as it is heavy. Always use safety gloves and enclosed footwear.
- Be careful not to damage the floors (e.g. parquet) when moving the appliance.
- Make sure the appliance is not near a heat source.
- Install and level the appliance on a floor strong enough to take its weight and in a place suitable for its size and use.
- Make sure the air can circulate around the appliance.
- At first installation or after reversing the door wait at least 4 hours before connecting the appliance to the power supply. This is to allow the oil to flow back into the compressor.
- Before carrying out any operations on the appliance (e.g. reversing the door), remove the plug from the power socket.
- The rear of the appliance must stand against the wall.
- Do not install the appliance where there is direct sunlight.
- Do not install this appliance in areas that are too humid or too cold such as wine cellars.

Electrical connection

- ⚠ **WARNING!** Risk of fire and electrical shock.
- ⚠ **WARNING!** When positioning the appliance, ensure the supply cord is not trapped or damaged.
- ⚠ **WARNING!** Do not use multi-plug adapters or extension cables.
- The appliance must be earthed.
- Make sure that the parameters on the rating plate are compatible with the electrical ratings of the mains power supply.
- Always use a correctly installed shockproof socket.
- Make sure not to cause damage to the electrical components (e.g. mains plug, mains cable, compressor). Contact an Authorised Service Centre or an electrician to change the electrical components.
- The mains cable must stay below the level of the mains plug.
- Connect the mains plug to the mains socket only at the end of the installation. Make sure that there is access to the mains plug after the installation.
- Do not pull the mains cable to disconnect the appliance. Always pull the mains plug.

Use

⚠ WARNING! Risk of injury, burns, electrical shock or fire.



The tubes of the refrigeration circuit contain a small quantity of the environmentally friendly but flammable refrigerant R600a. It does not damage the ozone layer and does not increase the greenhouse effect. If refrigerant escapes, it may injure your eyes or ignite. Do not damage the tubes.

- The surface of the compressor may become hot under normal operation. Do not touch it with hands.
- Do not change the specifications of this appliance.
- Do not put electrical appliances (e.g. ice cream makers) in the appliance unless they are stated applicable by the manufacturer.
- If damage occurs to the refrigerant circuit, make sure that there are no flames and sources of ignition in the room. Ventilate the room.
- Do not let hot items touch the plastic parts of the appliance.
- Do not store bottled drinks in the freezer compartment to prevent burst or other losses.
- Do not store flammable gases or liquids in the appliance.
- Do not put flammable products or items that are wet with flammable products in, near or on the appliance.
- Do not touch the compressor or the condenser. They are hot.
- Do not remove or touch items from the frozen-food compartment if your hands are wet or damp.
- Do not swallow the contents (non-toxic) of the ice packs.
- Do not eat ice cubes or ice lollies immediately after taking them out of the freezer since they may cause cold burns.
- Thawed food should not be put back in the frozen-food compartment.
- Follow the storage instructions on the packaging of frozen food.

Internal lighting

⚠ WARNING! Risk of electric shock.

- The bulb used inside the appliance is specifically designed for domestic appliances and is not suitable for general room lighting within the home.

Care and cleaning

⚠ WARNING! Risk of injury or damage to the appliance.

- Before maintenance, deactivate the appliance and disconnect the mains plug from the mains socket.
- This appliance contains hydrocarbons in the cooling unit. Only a qualified person can do the maintenance and the recharging of the unit.
- Regularly examine the drain of the appliance and if necessary, clean it. If the drain is blocked, defrosted water collects at the bottom of the appliance.

Service

- To repair the appliance contact an Authorised Service Centre listed at the end of this manual.
- Use original spare parts only.

Disposal

⚠ WARNING! Risk of injury or suffocation.

- Disconnect the appliance from the mains supply.
- Cut off the mains cable and discard it.
- Remove the doors to prevent children and pets to be closed inside the appliance.
- The refrigerant circuit and the insulation materials of this appliance are ozone-friendly.
- The insulation foam contains flammable gas. Contact your municipal authority for information on how to discard the appliance correctly.
- Do not cause damage to the part of the cooling unit that is near the heat exchanger.

The manufacturer declines any liability for injury to persons or animals or damage to property if the above advice and precautions are not respected.

Installation

⚠ WARNING! Before installing the appliance, carefully read the safety information in this booklet.

Installation checklist

Door

- Door seals completely to cabinet on all sides
- Door is level

Levelling

- Refrigerator is level

Electrical power

- Wait 4 hours
- House power turned on
- Refrigerator plugged in

Final checks

- Packing materials removed
- Refrigerator temperature set

Positioning

- Follow the separate Assembly Instructions to install this appliance.
- Install this appliance at a location where the ambient temperature corresponds to the climate class indicated on the rating plate of the appliance. This ensures the correct operation of the appliance. Explanation of climate classes is as follows:

Climate class	Ambient temperature range
SN	+10°C to +32°C
N	+16°C to +32°C
ST	+16°C to +38°C
T	+16°C to +43°C

- "SN" indicates that this refrigerating appliance is intended to be used at ambient temperatures ranging from 10°C to 32°C.
- "N" indicates that this refrigerating appliance is intended to be used at ambient temperatures ranging from 16°C to 32°C.
- "ST" indicates that this refrigerating appliance is intended to be used at ambient temperatures ranging from 16°C to 38°C.
- "T" indicates that this refrigerating appliance is intended to be used at ambient temperatures ranging from 16°C to 43°C.

ⓘ For some models of appliances, some functional problems can occur when they operate outside the specified temperature ranges. The correct operation can only be guaranteed within the specified temperature ranges. If you have any doubts regarding installation, please turn to the vendor, our customer service or the nearest Authorised Service Centre.

Location

To ensure best performance, install the appliance well away from sources of heat such as radiators, boilers, and direct sunlight. Make sure that air can circulate freely around the back of the cabinet.

Levelling the appliance

If the appliance tilts in some way, adjust the two feet at the front of the appliance to level the appliance. Refer to the separate Assembly Instructions for detailed instructions.

1. Disconnect the mains plug of the appliance from the power socket.
2. Turn the foot clockwise to raise the appliance. Turn the foot anticlockwise to lower the appliance.

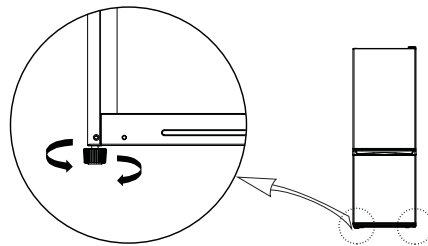

Cleaning the appliance

Before using the appliance for the first time, clean the appliance to remove the typical smell of a brand-new product.

1. Make sure the appliance is disconnected from the power supply.
2. Wipe the interior with a soft, moistened cloth.
3. Wash the internal accessories with lukewarm water and some neutral soap, then dry thoroughly.

CAUTION!

Do not use abrasive, chloride or acidic cleaning agents or solvents.

- Do not use scouring or abrasive sponges. The metallic surfaces may corrode.
- Never clean the accessories using a dishwasher. They may become deformed.

Electrical connection

⚠ CAUTION! Any electrical work required to install this appliance should be carried out by a qualified electrician or competent person.

⚠ WARNING! This appliance must be earthed. Failure to follow these instructions can result in death, fire or electrical shock.

The manufacturer declines any liability should these safety measures not be observed.

First use

Connect the appliance to the power supply. The ideal food storage temperatures are already factory-set (intermediate).

Note: After being switched on, the appliance needs 4-5 hours in order to reach the correct temperature to store a typical volume of food.

Product description

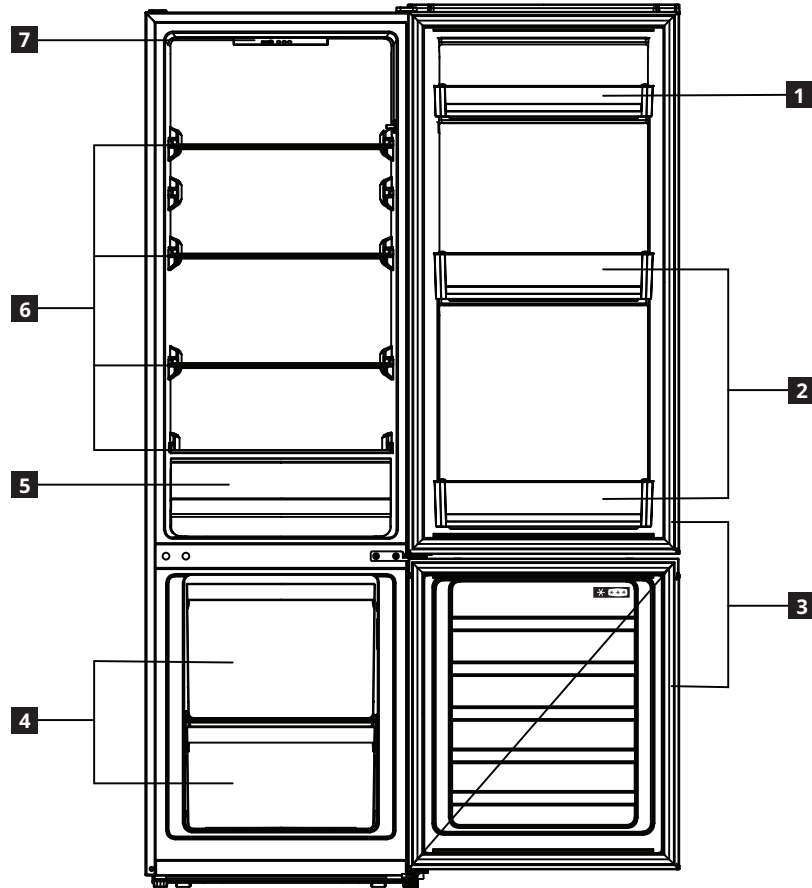

- 1** Door balcony
- 2** Bottle balconies
- 3** Door gaskets
- 4** Freezer drawers

- 5** Vegetable drawer
- 6** Glass shelves
- 7** Control panel

Operation

Control panel

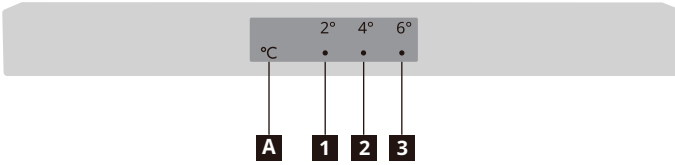

1 2°C indicator

2 4°C indicator

3 6°C indicator

A Temperature setting button

Note: Do not use sharp objects to operate the control panel. They can scratch or damage the control panel.

Switching on

When you connect the mains plug to a power socket, the appliance switches on and starts operating.

Display

In case of a temperature sensor failure, the corresponding indicator will blink.

Indicator status	Fault
The 2°C indicator (1) is blinking.	Refrigerator temperature sensor failure
The 4°C indicator (2) is blinking.	Refrigerator defrosting temperature sensor failure
The 6°C indicator (3) is blinking.	Ambient temperature sensor failure

Note: If there is a flashing failure, please call the service center.

Setting the temperature

Recommended temperature

Refrigerator compartment: +4°C (factory setting)

- You can set the temperature of the refrigerator compartment via the control panel.
- You cannot directly set the temperature of the freezer compartment. But the colder the refrigerator compartment, the colder the freezer compartment.
- When the appliance is plugged in for the first time, it sets the temperature to 4°C. When you plug in or switch on the appliance again, it sets the temperature to the last set temperature.

To set the temperature, press the temperature setting button **A** one or more times until the indicator for the desired set temperature lights up. The appliance will operate according to the new set temperature in 30 seconds.



Tips:

- The lower the set temperature, the longer you can safely store your food and the more electricity the appliance consumes.
- The higher the set temperature, the quicker your stored food decays and the less electricity the appliance consumes.

Super cooling mode

- To put the appliance into super cooling mode, press and hold the temperature setting button **A** for 3 seconds. Both the 2°C and 4°C indicators light up and the appliance enters super cooling mode in 30 seconds.

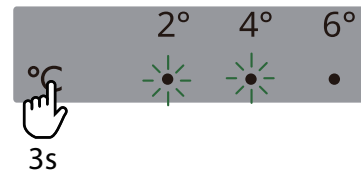

- The appliance will automatically exit super cooling mode after 6 hours. To exit this mode earlier, press the temperature setting button **A**.

Super freezing mode

- To put the appliance into super freezing mode, press and hold the temperature setting button **A** for 6 seconds. Both the 4°C and 6°C indicators light up and the appliance enters super freezing mode in 30 seconds.

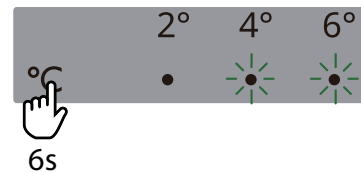

- The appliance will automatically exit super freezing mode after 40 hours. To exit this mode earlier, press the temperature setting button **A**.

Switching off

To switch off the appliance, disconnect the mains plug from the power socket.

Refrigerator compartment

Hints for fresh food refrigeration

- Cover or wrap the food, particularly if it has a strong flavour.
- Position the food so that air can circulate freely around it.
- For best performance, leave enough space in the refrigerator compartment for air to circulate around the packages. Also leave enough room at the front so the door can close tightly.
- Do not store warm food or evaporating liquids in the refrigerator.
- Meat (all types): wrap in suitable packaging and place on the glass shelf above the vegetable drawer. Store meat for at most 1-2 days.
- Cooked foods and cold dishes: cover and place on any shelf.
- Fruit and vegetables: clean thoroughly and place in the vegetable drawer. Bananas, potatoes, onions and garlic must not be kept in the refrigerator if not packed.
- Butter and cheese: place in special airtight containers or wrap in aluminium foil or polythene bags to exclude as much air as possible.
- Bottles: close with caps and place on the door balconies.

Movable shelves

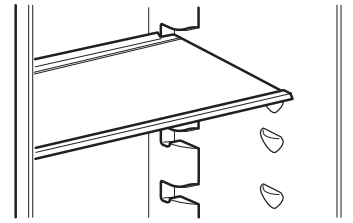

Picture for reference only

- The walls of the refrigerator are equipped with a series of runners so that the safety glass shelves can be positioned as desired.

Vegetable drawer

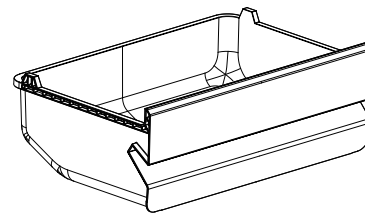

Picture for reference only

- The drawer is suitable for storing fruit and vegetables.
- The drawer can be pulled out for cleaning.

Freezer compartment

Hints for freezing fresh food

- The quantity of fresh food that can be frozen in 24 hours is shown on the rating plate.
- When first starting-up or after a period out of use, before putting the products in the compartment let the appliance run for at least 2 hours on a colder setting.
- Do not allow fresh, unfrozen food to touch food which is already frozen, thus avoiding a rise in temperature of the latter.
- If you need to freeze fresh food on a daily basis, try to reduce the quantity of food to be frozen at a time.
- Wrap food to protect it from any water, humidity or condensation; this will prevent the spread of any odours in the refrigerator, while also ensuring better storage of frozen food.
- Lean foods store better and longer than fatty ones; salt reduces the storage life of food.
- Never place warm food in the freezer. Cooling hot foods before freezing saves energy and prolongs the life of the appliance.
- Do not refreeze partially thawed food.
- **Note:** Never put bottled food or drinks in the frozen-food compartment.

- For best performance, leave enough space in the frozen-food compartment for air to circulate around the packages. Also leave enough room at the front so the door can close tightly.

Hints for storing frozen food

To obtain the best performance from this appliance, you should:

- Make sure that the commercially frozen foodstuffs were adequately stored by the retailer.
- Make sure that frozen foodstuffs are transferred from the food store to the frozen-food compartment in the shortest possible time.
- Do not open the door frequently or leave it open longer than absolutely necessary.
- Once defrosted, food deteriorates rapidly and cannot be refrozen.
- Do not exceed the storage period indicated by the food manufacturer.
- During manual defrosting, maintenance or cleaning, a rise in temperature of the frozen food may shorten its storage period.

Thawing

Deep-frozen or frozen food, prior to being used, can be thawed in the refrigerator compartment or at room temperature, depending on the time available for this operation.

Small pieces may even be cooked still frozen, directly from the frozen-food compartment: in this case, cooking will take longer.

Daily use

To lower the energy consumed by the appliance, follow these tips:

- Install the appliance in a dry, well ventilated room far away from any heat source (e.g. radiator, cooker, etc.) and in a place not exposed directly to the sun. If required, use an insulating plate.
- To guarantee adequate ventilation follow installation instructions.
- Insufficient ventilation on back of the product increases energy consumption and decreases cooling efficiency.
- The internal temperatures of the appliance may be affected by the ambient temperature, frequency of door opening, as well as location of the appliance. Temperature setting should take into consideration these factors.

⚠ WARNING! In the event of accidental defrosting, for example the power has been off for longer than the temperature rising time shown on the rating plate of the appliance, the defrosted food must be consumed quickly or cooked immediately and then re-frozen (after being cooked).

- Allow warm food and drinks to cool down before placing in the appliance.
- Do not obstruct the fan (if available) with food items.
- After placing or removing food, ensure you close the door properly, especially the freezer door.
- Reduce to a minimum door opening.
- When thawing frozen food, place them in the refrigerator. The low temperature of the frozen products cools the food in the refrigerator.
- Positioning of the shelves in the refrigerator has no impact on the efficient usage of energy. Food should be placed on the shelves in such way to ensure proper air circulation (food should not touch each other and distance between food and rear wall should be kept).
- Damaged gaskets must be replaced as soon as possible.

Cleaning and maintenance

General tips

- Regularly clean the appliance with a cloth and a solution of warm water and neutral detergent specifically formulated for refrigerator interiors. Do not use abrasive cleaners or tools.
- Use the tube cleaner provided in the accessory bag to regularly clean the defrost water drain hole at the back of the refrigerator compartment. This will ensure the defrost water drains properly, and prevent the water from overflowing and dripping onto the food inside.
- Before servicing or cleaning the appliance, unplug it from the mains or disconnect the power supply.

CAUTION! The refrigerator accessories must not be placed in a dishwasher.

Defrosting the refrigerator compartment

Food moisture evaporating inside the refrigerator or the entry of air moisture into the refrigeration compartment during daily use can both lead to frost formation in the refrigeration compartment. In such cases, manually raising the temperature setting of the refrigerator can facilitate automated defrosting. The formation of water droplets on the rear wall of the refrigerator compartment indicates that the automatic defrosting is underway.

The defrost water automatically runs into the drain outlet and then into a container where it evaporates.

CAUTION! The refrigerator accessories must not be placed in a dishwasher.

Defrosting the freezer compartment

It is perfectly normal for ice to form. The amount of ice which forms and the rate at which it accumulates will depend on ambient temperature and humidity, and on the frequency of door opening.

1. Set the coldest temperature four hours before removing food from the freezer compartment, so as to extend the storage time of food during defrosting.
2. Switch the appliance off and remove the drawers. Place the frozen food in a cool place.
3. Leave the freezer door open to allow the frost to melt. To prevent water leaking onto the floor during defrosting, place an absorbent cloth on the bottom of the freezer compartment and wring it out regularly.
4. Clean the interior of the freezer. Rinse and dry carefully.
5. Switch the appliance on again and place food back in the freezer compartment.

If you do not use the appliance for a prolonged period

1. Switch off the appliance.
2. Disconnect the appliance from the power supply.
3. Remove all food.
4. Defrost and clean the appliance.
5. Leave the doors open just enough to allow air to circulate inside the compartments. This will prevent the formation of mould and unpleasant odours.

In the event of a power cut

- Keep the doors of the appliance closed. This will allow the food to stay cold as long as possible.
- If food has defrosted even partially, do not re-freeze it. Consume within 24 hours.

Replacing the lamp

The appliance is equipped with a lamp for interior lighting.

Only service is allowed to replace the lighting device. Please reach out to IKEA. Refer to www.IKEA.com and select your local store for local store phone numbers and opening times.

Troubleshooting

Problem	Possible Cause	Solution
The appliance does not operate.	The appliance is switched off.	Switch on the appliance.
	The mains plug is not connected to the mains socket correctly.	Connect the mains plug to the mains socket correctly.
	There is no voltage in the mains socket.	To find out if the mains socket is working, connect a different electrical appliance to it. Contact a qualified electrician to repair the socket.
The appliance is noisy.	The appliance is not placed stably.	Level the appliance. Refer to "Levelling the appliance", or the separate Assembly Instructions.
The lamp does not work.	The lamp is defective.	Refer to "Replacing the lighting".
The compressor runs continuously.	The set temperature is too low.	Set a higher temperature. Refer to "Operation".
	Many food products were inserted at the same time.	Wait some hours and then check the temperature again.
	The room temperature is too high.	Reposition the appliance if possible. Refer to "Positioning".
	Food products placed in the appliance were too warm.	Allow food products to cool to room temperature before storing.
The temperature in the appliance is too low/too high.	The door is not closed correctly.	Refer to "Closing the door".
	The temperature was not set correctly.	Set a higher/lower temperature.
	The door is not closed correctly.	Refer to "Closing the door".
	Food products placed in the appliance were too warm.	Allow food products to cool to room temperature before storing.
	Many food products were inserted at the same time.	Insert less food products at the same time.
	The thickness of ice in the freezer compartment is greater than 4-5 mm.	Defrost the freezer compartment. Refer to "Defrosting the freezer compartment".
	Door was opened too frequently.	Open the door only when necessary.
There is not enough cold air circulation in the appliance.	Reposition the food so that air can circulate freely in the appliance.	

Problem	Possible Cause	Solution
There is too much condensed water on the rear wall of the refrigerator.	Door was opened too frequently.	Open the door only when necessary.
	Door was not closed completely.	Make sure the door is closed completely. Refer to "Closing the door".
	Stored food was not wrapped.	Wrap food in suitable packaging before storing it in the appliance.
Water flows inside the refrigerator.	The drain hole at the back of the appliance is clogged.	Clean the drain hole with the supplied tool.
	Food products prevent water from flowing into the water collector.	Make sure that food products do not touch the rear wall.
Water flows on the floor.	The door is not closed well.	Refer to "Closing the door".
	The appliance tilts forward.	Tilt the appliance slightly backward (6mm lower at the back). Refer to the separate Assembly Instructions for more details.
	The drip pan cracked.	Contact an Authorised Service Centre listed at the end of this manual.
	The drain hole at the back of the appliance is clogged.	Clean the drain hole with the supplied tool.
The door does not close completely.	Refer to "Closing the door".	Refer to "Closing the door".

Normal noises

It is normal for the refrigeration system to produce some noises, such as gurgling and hissing.

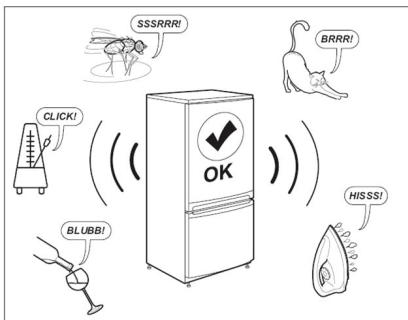

Closing the door

If	Do
Door gaskets are dirty.	Clean them.
Door gaskets are damaged.	Contact the After Sales Service to replace them.
The door is blocked by shelves, drawers, food items, etc.	Position correctly or remove the objects that block the door.
The appliance is not level.	Level the appliance. Refer to "Levelling the appliance", or the separate Assembly Instructions.
The door is not aligned with the cabinet.	Adjust the door. Refer to the separate Assembly Instructions.

Before contacting the After-sales Service:

Restart the appliance to see if the fault has been remedied. If it persists, switch the appliance off again and repeat the operation after an hour.

If your appliance still does not work properly after carrying out the checks listed in the troubleshooting guide and switching the appliance on again, contact the After-sales Service, clearly explaining the problem and specifying:

- the nature of the problem
- the date of purchase
- the model and serial number of the appliance

i The article number and serial number are shown on the rating plate on the internal left side of the appliance.

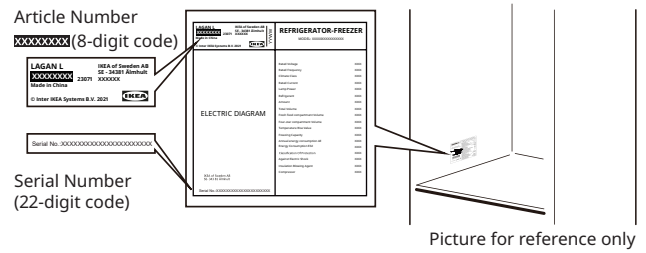

Technical information

Product category	
Product type	Refrigerator-Freezer
Installation type	Freestanding
Product dimensions	
Height	1773 mm
Width	547 mm
Depth	568 mm
Net volume	
Fridge	197 L
Freezer	65 L
Defrost system	
Fridge	Manual
Freezer	Manual
Other specifications	
Temperature rising time	10 hours
Refrigerating capacity	10 kg/12h
Freezing capacity	1.5 kg/12h
Energy consumption	Standard: 0.590 kW·h/24h , 215 kW·h/a Overall: 0.690 kW·h/24h , 252 kW·h/a
Noise level	38 dB(A)
Energy class	Class 3
Rated voltage	220 V~
Rated frequency	50 Hz
Standards used	GB4706.1 GB4706.13 GB4343.1 GB17625.1 GB19606 GB12021.2 GB/T8059

Food contact list

Tips

The parts in this list include parts of different product models. Some of these parts may not be included in the specific product you have purchased.

List of food contact materials		
Part name	Part materials	Standards used
Liner	PS/Aluminum plate/PCM/ABS	GB4806.1/GB4806.7/GB4806.9
Drawer	PS/PP/ABS	GB4806.1/GB4806.7
Cabinet frame	ABS/PS	GB4806.1/GB4806.7
Vegetable drawer, Bottle balcony, Egg holder, Lampshade, etc.	PS/ABS	GB4806.1/GB4806.7
Shelf assembly	Glass/PS/PP/ABS/Steel wire + Epoxy resin, etc.	GB4806.1/GB4806.5/GB4806.7/GB4806.9/GB4806.10
Ice machine and Water pipe	POM/PP/ABS/PS/Stainless steel/Aluminum pipe/Silicone rubber, etc.	GB4806.1/GB4806.7/GB4806.9/GB4806.11
Air duct components	PP/PS/Aluminum alloy/Cold rolled steel plate	GB4806.1/GB4806.7/GB4806.9
Plane light source components	PMMA, etc.	GB4806.1/GB4806.7
Preservation components	ABS	GB4806.1/GB4806.7
Temperature control box, knob, box cover, etc.	Flame-retardant PS/PS/ABS	GB4806.1/GB4806.7
Drip pan, Decorative strip, Bar, Hole plug, etc.	ABS/PP/Chrome plating + Steel wire	GB4806.1/GB4806.7/GB4806.9
Wire tube evaporator, Inflation evaporator, etc.	Cold rolled steel plate + Epoxy resin/Copper pipe/Aluminum pipe, etc.	GB4806.1/GB4806.9/GB4806.10

Remark: The parts in the above list are a summary of the main parts included in different models of products. Some of these parts may not be included in the specific product you have purchased.

Hazardous substances in the product

List of hazardous substances in the product										
Part name	Hazardous substance									
	Lead (Pb)	Mercury (Hg)	Cadmium (Cd)	Hexavalent chromium (Cr(VI))	Polybrominated biphenyls (PBBs)	Polybrominated diphenyl ethers (PBDEs)	Di-n-butyl phthalate (DBP)	Diisobutyl phthalate (DIBP)	Benzyl butyl phthalate (BBP)	Di(2-ethylhexyl) phthalate (DEHP)
Cabinet and its components	○	○	○	○	○	○	○	○	○	○
Doors and their components	○	○	○	○	○	○	○	○	○	○
Compressor components and accessories	✕	○	○	○	○	○	○	○	○	○
PCB	✕	○	○	○	○	○	○	○	○	○
Refrigeration piping parts	○	○	○	○	○	○	○	○	○	○
Refrigerant	○	○	○	○	○	○	○	○	○	○
Electrical components	✕	○	○	○	○	○	○	○	○	○
Packaging and printed components	○	○	○	○	○	○	○	○	○	○
Auxiliary materials	○	○	○	○	○	○	○	○	○	○

Explanation of symbols:
 ○ : Indicates that the content of the hazardous substance in all homogeneous materials of the part does not exceed the requirement of the national standard for the restriction of the use of hazardous substances in electrical and electronic products.
 ✕: Indicates that the content of the hazardous substance in at least one homogeneous material of the part exceeds the requirement of the national standard for the restriction of the use of hazardous substances in electrical and electronic products.

Note: For those parts not listed above, the content of all hazardous substances in them does not exceed the requirements of the national standard for the restriction of the use of hazardous substances in electrical and electronic products.

Environmental requirements

Please recycle materials marked with the symbol . Please put the packaging in the corresponding container for recycling. Please protect the environment and human health by recycling used and scrapped electrical and electronic devices. Do not dispose of this product together with ordinary domestic waste. Please send the product to a local recycling facility or contact your municipal office for directions.



IKEA Guarantee

How long is the IKEA guarantee valid?

This guarantee is valid for **five (5) years** from the original date of purchase of your appliance at IKEA. The original sales receipt is required as proof of purchase. If service work is carried out under guarantee, it will not extend the guarantee period for the appliance.

Which LAGAN appliances are not covered by the IKEA 5-year guarantee?

LAGAN appliances purchased from IKEA before 1 May 2026 are covered by a 2-year guarantee, starting from the original date of purchase.

Who will execute the service?

IKEA service provider will provide the service through its own service operations or authorized service partner network.

What does this guarantee cover?

The guarantee covers faults of the appliance, which have been caused by faulty construction or material faults from the date of purchase from IKEA. This guarantee applies to domestic use only. The exceptions are specified under the headline "What is not covered under this guarantee?" Within the guarantee period, the costs to remedy the fault e.g. repairs, parts, labour and travel will be covered, provided that the appliance is accessible for repair without special expenditure. On these conditions the respective local regulations are applicable. Replaced parts become the property of IKEA.

What will IKEA do to correct the problem?

IKEA appointed Service Provider will examine the product and decide, at its sole discretion, if it is covered under this guarantee. If considered covered, IKEA Service Provider or its authorized service partner through its own service operations, will then, at its sole discretion, either repair the defective product or replace it with the same or a comparable product.

What is not covered under this guarantee?

- Normal wear and tear.
- Deliberate or negligent damage, damage caused by failure to observe operating instructions, incorrect installation or by connection to the wrong voltage, damage caused by chemical or electro-chemical reaction, rust, corrosion or water damage including but not limited to damage caused by excessive lime in the water supply, damage caused by abnormal environmental conditions.
- Consumable parts including batteries and lamps.
- Non-functional and decorative parts which do not affect normal use of the appliance, including any scratches and possible color differences.
- Accidental damage caused by foreign objects or substances and cleaning or unblocking of filters, drainage systems or soap drawers.
- Damage to the following parts: ceramic glass, accessories, crockery and cutlery baskets, feed and drainage pipes, seals, lamps and lamp covers,

screens, knobs, casings and parts of casings.

Unless such damages can be proved to have been caused by production faults.

- Cases where no fault could be found during a technician's visit.
- Repairs not carried out by our appointed service providers and/or an authorized service contractual partner or where non-original parts have been used.
- Repairs caused by installation which is faulty or not according to specification.
- The use of the appliance in a non-domestic environment i.e. professional use.
- Transportation damages. If a customer transports the product to his home or another address, IKEA is not liable for any damage that may occur during transport. However, if IKEA delivers the product to the customer's delivery address, then damage to the product that occurs during this delivery will be covered by IKEA.
- Cost for carrying out the initial installation of the IKEA appliance.
- However, if an IKEA appointed Service Provider or its authorized service partner repairs or replaces the appliance under the terms of this guarantee, the appointed Service Provider or its authorized service partner will reinstall the repaired appliance or install the replacement, if necessary.
- All plumbing and electrical installation, are not the responsibility of IKEA, and customer must complete these work before the execution work.

How country law applies

The IKEA warranty gives you specific legal rights, which cover or exceed all the local legal demands. However these conditions do not limit in any way consumer rights described in the local legislation.

Area of validity

This warranty is valid only in the country where the product has been purchased; the services will be provided in the framework of the guarantee conditions. An obligation to carry out services in the framework of the guarantee exists only if the appliance complies and is installed in accordance with:

- the technical specifications of the country in which the guarantee claim is made;
- the Assembly Instructions and User Manual Safety Information;

The dedicated AFTER SALES for IKEA appliances

Please don't hesitate to contact IKEA appointed Authorized Service Centre to:

- make a service request under this guarantee;
- ask for clarifications on installation of the IKEA appliance in the dedicated IKEA kitchen furniture;
- ask for clarification on functions of IKEA appliances.

To ensure that we provide you with the best assistance, please read carefully the Assembly Instructions and/or the User Manual before contacting us.

How to reach us if you need our service



The IKEA after sales customer service center will assist you on the phone with basic troubleshooting for your appliances at the time of service call request.

Please refer to

www.IKEA.com

and select your local store for local store phone numbers and opening times.

Before calling us, assure that You have to hand the IKEA article number (8 digit code) and the Serial Number (22 digit code that can be found on the rating plate) for the appliance of which you need our assistance.

- ⓘ **SAVE THE SALES RECEIPT!** It is your proof of purchase and required for the guarantee to apply. Note that the receipt reports also the IKEA article name and number (8 digit code) for each of the appliances you have purchased.

Do you need extra help?

For any additional questions not related to After Sales of your appliances please contact your nearest IKEA store call centre. We recommend you read the appliance documentation carefully before contacting us.

目录

安全信息.....	20	日常使用.....	26
安全说明.....	21	清洁与维护.....	26
安装.....	22	故障排除.....	27
首次使用.....	23	技术规格.....	29
产品描述.....	23	食品接触清单.....	30
操作.....	24	环保清单.....	31
冷藏室.....	25	环保要求.....	31
冷冻室.....	25	宜家质保.....	32

安全信息

安装和使用冰箱前，请仔细阅读产品说明书。因安装不正确或使用错误所导致的人身伤害或设备损坏，制造商概不负责。请将说明书与冰箱一同妥善保存，以备将来参阅。

儿童和弱势群体安全指南



警告： 火灾风险 / 易燃材料

- 器具不打算由存在肢体、感官或精神能力缺陷或缺少使用经验和知识的人（包括儿童）使用，除非有负责他们安全的人对他们进行与器具使用有关的监督或指导。
- 应照看好儿童，确保他们不玩耍本器具。
- 将所有包装远离儿童放置，并妥善处理。

基本安全指南

- 本电器适用于家庭及以下类似场景：
 - 商店、办公室和其他工作环境内的员工厨房区域；
 - 农舍、酒店、汽车旅馆，以及其他居住环境；
 - B&B（住宿加早餐）类型的环境；
 - 餐饮和非零售行业应用场景。
- **警告：** 器具周围或在嵌入式结构里无阻碍物，保持通风通畅。
- **警告：** 除了制造商推荐的方式外，不得使用机械设备或其他方式加速除霜过程。
- **警告：** 不得损坏制冷回路。
- **警告：** 除了制造商推荐使用的类型外，不得在器具的食品储藏室使用电器。

- **警告：** 请勿使用水喷雾和蒸汽清洁冰箱。
- **警告：** 请使用微湿的软布擦拭冰箱。仅使用中性洗涤剂。请勿使用磨蚀性产品、磨蚀性清洁垫、溶剂或金属物品清洗。
- **警告：** 不得在器具中贮存爆炸物，如助燃喷雾剂。
- **警告：** 如果电源软线损坏，为了避免危险，必须由制造商、其维修部或类似部门的专业人员更换。
- **警告：** 安放冰箱时，请确保电源软线没有卡住或损坏。
- **警告：** 请勿在冰箱后面放置多个便携式插座或便携式电源。
- 长时间打开冰箱门会导致内部隔室温度显著升高。
- 定期清洁可能接触到食物和靠近排水系统的表面。
- 如果水箱已 48 小时未使用，则应清洁后再启用；如果连续 5 天未取水，则应冲洗与供水系统相连的管件。
- 生肉和鱼应装在适当容器内再放入冰箱，以免接触或滴到其他食物上。
- 如果冰箱长期空置，应关闭电源，进行除霜、清洁和干燥，并保持冰箱门开启，以防内部产生霉菌。
- 该冰箱不能用作嵌入式安装。
- 二星冷冻食品室适合储存预冻食品、储存或制作冰激凌以及制作冰块。
- 一星、二星和三星隔室不适合冷冻生鲜食品。
- **警告：** 请务必按照说明书安装，以免冰箱安装不稳造成危险。

安全说明

安装

⚠ 警告！ 冰箱必须由具备资质的人员进行安装。

- 请移除所有包装。
- 请勿安装或使用已损坏的冰箱。
- 请按照冰箱随附的安装说明书进行安装。
- 冰箱较重，请小心移动。始终佩戴安全手套并穿着封闭式鞋子。
- 移动冰箱时，请小心不要损坏地板（如镶木地板）。
- 确保冰箱远离热源。
- 将冰箱安装在足以承受其重量的地面上，并保持水平，安装位置应与其尺寸和用途相适应。
- 请确保冰箱周围的空气正常流通。
- 初次安装或更换冰箱门方向后，请务必等待至少 4 个小时再接通电源，以确保油液能够回流至压缩机中。
- 在对冰箱进行任何操作（如更换门的方向）之前，请将插头从电源插座上拔下。
- 冰箱背面应当紧贴墙壁放置。
- 请勿将冰箱安装在阳光直射的地方。
- 请勿将冰箱安装在过于潮湿或寒冷的地方，例如酒窖内。

电气连接

⚠ 警告！ 存在火灾和触电风险。

⚠ 警告！ 安放冰箱时，请确保电源软线没有卡住或损坏。

⚠ 警告！ 请勿使用接线板或电源延长线。

- 冰箱必须接地。
- 确保铭牌上的电气参数与主电源的电气参数相匹配。
- 务必使用正确安装的防电击插座。
- 确保不会损坏电气部件（例如电源插头、电源线、压缩机）。请联系授权服务中心或电工更换电气部件。
- 电源线位置必须低于电源插头。
- 安装完成后，方可连接电源插头至主电源插座。安装完成后，请确保电源插头仍然便于插拔。
- 在切断冰箱电源时，请勿直接拉拽电源线，应始终通过拔下电源插头来进行断电操作。

使用

⚠ 警告！ 存在人身伤害、烧伤、触电或火灾风险。



制冷系统的管道内含少量环保但易燃的制冷剂 R600a。本电器不会破坏臭氧层，也不会加剧温室效应。如果制冷剂泄漏，可能会损伤眼睛或引发燃烧。请勿损坏管道。

- 压缩机正常工作时表面可能发烫，请勿用手触摸。
- 请勿更改冰箱的规格。
- 除非制造商声明适用，否则不要将电器（例如冰淇淋机）放入冰箱中。
- 如果制冷回路损坏，请确保室内无明火和火源，并进行通风。
- 请勿让高温物体接触冰箱的塑料部件。

- 切勿在冷冻室内存放瓶装饮料，以防爆裂或发生其他损失。
- 请勿在冰箱内存放可燃气体或液体。
- 请勿将易燃产品或沾有易燃液体的物品放在冰箱内部、附近或上方。
- 请勿触摸压缩机或冷凝器等发热部件。
- 请勿用湿手触碰或取出冷冻食品室内的物品。
- 冰袋内容物虽无毒，但请勿吞咽。
- 刚从冷冻室中取出冰块或冰棍时，请勿立即食用，以防冻伤。
- 请勿将解冻后的食物放回冷冻食品室。
- 请遵循冷冻食品包装上的储存说明。

内置灯

⚠ 警告！ 存在触电风险。

- 冰箱内使用的灯泡是专为家用电器设计的，不适用于家庭一般照明。

保养与清洁

⚠ 警告！ 存在人身伤害或冰箱损坏的风险。

- 在进行维护前，请关闭冰箱并将电源插头从插座上拔下。
- 冰箱的冷却装置中含有碳氢化合物。须由具备资质的人员维护和填充冷却装置。
- 请定期检查冰箱排水口，必要时进行清理。如果排水口被堵塞，除霜水会积聚在冰箱底部。

服务

- 如需修理冰箱，请联系本手册末尾所列的授权服务中心。
- 仅使用原装配件。

废弃处理

⚠ 警告！ 存在人身伤害或窒息的风险。

- 断开冰箱的主电源。
- 切断电源线并丢弃。
- 卸下冰箱门，以防儿童或宠物被关在冰箱内。
- 冰箱的制冷回路和绝缘材料对臭氧层无害。
- 绝缘泡沫含有可燃气体。请您联系所在地的市政部门，了解如何妥善处理或丢弃此冰箱。
- 请勿损坏靠近热交换器的冷却装置部分。

若不遵守上述建议和预防措施，制造商对因此导致的人员或动物伤害以及财产损失不承担任何责任。

安装

警告! 在安装冰箱之前，请仔细阅读本手册中的安全信息。

安装检查清单

- 门体与箱体四周紧密贴合
- 门体平稳
- 调平
- 冰箱平稳
- 电源
- 等待 4 小时
- 接通家用电源
- 插上冰箱插头
- 最终检查
- 移除包装材料
- 设置冰箱温度

选位

- 安装冰箱时，请参照《安装说明》。
- 请将冰箱安装在环境温度符合冰箱铭牌所示气候等级要求的位置，以确保冰箱正常运行。气候等级说明如下：

气候等级	环境温度范围
亚温带型 (SN)	+10° C 至 +32° C
温带型 (N)	+16° C 至 +32° C
亚热带型 (ST)	+16° C 至 +38° C
热带型 (T)	+16° C 至 +43° C

- “SN”表示该冰箱适宜在 10°C 至 32°C 的环境温度下使用。
- “N”表示该冰箱适宜在 16°C 至 32°C 的环境温度下使用。
- “ST”表示该冰箱适宜在 16°C 至 38°C 的环境温度下使用。
- “T”表示该冰箱适宜在 16°C 至 43°C 的环境温度下使用。

警告! 如果器具在额定气候类型（环境温度范围）以外运行，则器具可能不能维持满意的间室温度。如您对设备安装有任何疑问，请向零售商、我们的客服中心或就近的授权服务中心咨询。

安装位置

为确保最佳性能，请将冰箱安装在远离热源（如散热器、热水炉、阳光直射等）的位置。确保冰箱背部周围的空气能够自由流通。

调平冰箱

如果冰箱倾斜，调整冰箱前部的两个支脚，将冰箱调平。详细安装指南请参阅《安装说明》。

1. 将冰箱的电源插头从电源插座上拔下。
2. 顺时针转动支脚以增加冰箱的高度。逆时针转动支脚以降低冰箱的高度。

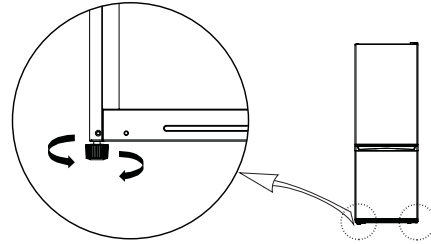

清洁冰箱

首次使用冰箱前，请清洁冰箱以去除新产品的气味。

1. 确保冰箱已断开电源。
2. 用柔软的湿布擦拭内部。
3. 使用温水和中性皂剂清洗内部和配件，然后彻底晾干。

警示!

请勿使用磨蚀性、含氯或酸性清洁剂或溶剂。

- 请勿使用磨蚀性或粗糙的海绵。金属表面可能会腐蚀。
- 切勿使用洗碗机清洗配件，以免其发生变形。

电气连接

警告! 安装冰箱所需的任何电气作业应由具备资质的电工或专业人员进行。

警告! 冰箱必须接地。未遵守上述说明可能导致死亡、火灾或触电。

若未遵守这些安全措施，制造商不承担任何责任。

首次使用

接通冰箱电源。出厂时已将理想的食物储存温度设置为中档。

注意：接通电源后，冰箱需要 4-5 小时才能达到适合储存一定量食物所需的适宜温度。

产品描述

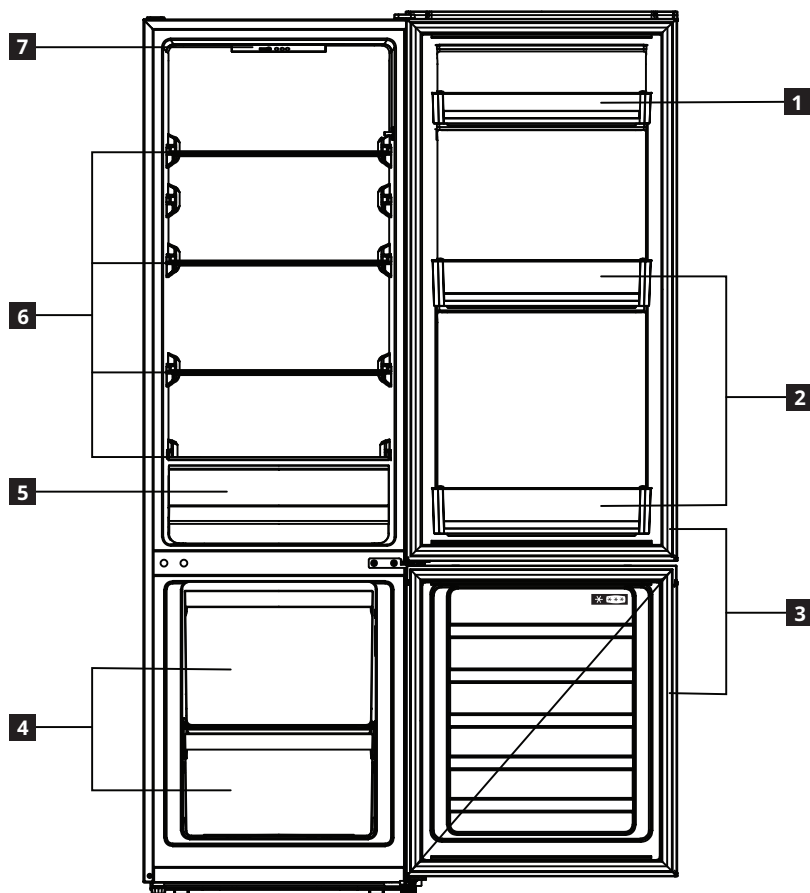

1 门搁架

2 瓶框

3 门封条

4 冷冻室抽屉

5 果菜盒

6 玻璃搁架

7 控制面板

操作

控制面板

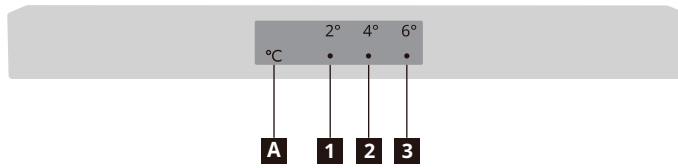

1 2° C 指示灯

2 4° C 指示灯

3 6° C 指示灯

A 温度设置按键

注意：请勿使用尖锐物体操作控制面板，以免划伤或损坏其表面。

启动

将电源插头连接到电源插座时，冰箱即接通并开始运行。

显示

如果温度传感器出现故障，相应的指示灯将闪烁。

指示灯状态	故障
2° C 指示灯 (1) 闪烁。	冰箱温度传感器故障
4° C 指示灯 (2) 闪烁。	冰箱除霜温度传感器故障
6° C 指示灯 (3) 闪烁。	环境温度传感器故障

注意：如果指示灯闪烁显示故障，请联系服务中心。

设置温度

推荐温度

冷藏室：+4° C（出厂设置）

- 您可以通过控制面板设置冷藏室的温度。
- 您无法直接设置冷冻室的温度，但冷藏室越冷，冷冻室也会随之变冷。
- 当冰箱首次接通电源时，它会将温度自动设定为 4° C。之后，每当您重新接通电源或打开冰箱时，它会恢复到上一次设置的温度。

要设置温度，请按温度设置按键 **A** 一次或多次，直到所需温度的指示灯亮起。冰箱将在 30 秒内按照新设定的温度开始运行。



提示：

- 设定温度越低，食品能安全储存的时间就越长，但冰箱消耗的电量也会相应增加。
- 设定温度越高，食品变质的速度就越快，同时冰箱消耗的电量也会相应减少。

速冷模式

- 要将冰箱设置为速冷模式，请长按温度设置按键 **A** 3 秒钟。2° C 和 4° C 指示灯同时亮起，冰箱将在 30 秒后进入速冷模式。

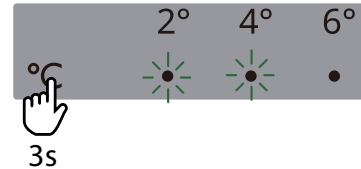

- 6 小时后，冰箱将自动退出速冷模式。若要提前退出此模式，请按下温度设置按键 **A**。

速冻模式

- 要将冰箱设置为速冻模式，请长按温度设置按键 **A** 6 秒钟。4° C 和 6° C 指示灯同时亮起，冰箱将在 30 秒后进入速冻模式。

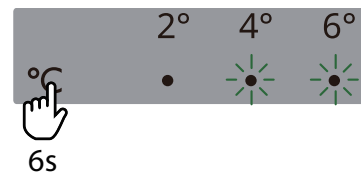

- 40 小时后，冰箱将自动退出速冻模式。若要提前退出此模式，请按下温度设置按键 **A**。

关闭

要关闭冰箱，请将电源插头从电源插座中拔出。

冷藏室

生鲜食品冷藏注意事项

- 请将食物妥善覆盖或包裹，特别是味道浓烈的食物。
- 正确摆放食物，确保周围的空气可以自由流通。
- 为使冰箱发挥最佳性能，请在冷藏室内保留一定空间，便于空气流通。冰箱前部需预留足够空间，确保门能完全关闭。
- 请勿在冰箱中储存温热食物或含有蒸汽的液体。
- 肉类（所有种类）：应适当包裹后，放置于果菜盒上方的玻璃架上。储存时间不宜超过 1-2 天。
- 熟食和凉菜：需盖好容器后，放在任意架子上。
- 水果和蔬菜：应彻底清洗后，放置于果菜盒内。请勿将未包装的香蕉、土豆、洋葱和大蒜放入冷藏室。
- 黄油和奶酪：应放在专门密封容器中，或用铝箔纸或塑料袋包裹，尽量排出空气。
- 瓶子：应盖好盖子后，放在门搁架上。

活动搁架

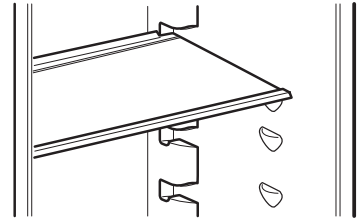

图片仅供参考

- 冷藏室内壁配备有滑轨，方便您根据需求调整安全玻璃搁架的位置。

果菜盒

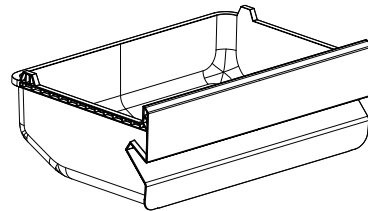

图片仅供参考

- 此抽屉适合用于存放水果和蔬菜。
- 此抽屉可以抽出进行清洗。

冷冻室

生鲜食品冷冻注意事项

- 冰箱铭牌上标注了 24 小时内可冷冻的生鲜食品数量。
- 若是首次使用或长时间未使用，请在放入食品前，让冰箱在低温设置下运行至少两个小时。
- 请避免未冷冻的生鲜食品与已冷冻食品接触，以防止后者温度升高。
- 如需每天冷冻生鲜食品，请尽量减少每次冷冻的食品量。
- 应将食品妥善包裹，防止其接触水分、湿气或冷凝物，这样既能防止冰箱内异味扩散，又能确保冷冻食品得到更好的保存。
- 脂肪含量少的食物比脂肪含量多的食物更易于储存且储存时间更长；而盐分会缩短食品的储存期限。
- 切勿将温热食物直接放入冷冻室。先将热食冷却后再冷冻，可以节约能源并延长冰箱使用寿命。
- 请勿重新冷冻已部分解冻的食物。
- **注意：**请勿将瓶装食物或饮料放入冷冻食品室。
- 为使冰箱发挥最佳性能，请在冷冻食品室内保留一定空间，便于空气流通。冰箱前部需预留足够空间，确保门能完全关闭。

冷冻食物储存注意事项

为使冰箱发挥最佳性能，您应当：

- 确保从零售商处购买的是已妥善储存的冷冻食品。
- 尽快将冷冻食品从储存盒转移到冷冻食品室内。
- 避免频繁开关冰箱门或让冰箱门长时间保持开启状态。
- 食物一旦解冻，很快就会变质，且不可重新冷冻。
- 储存时，务必遵守食品制造商规定的储存期限。
- 在进行手动除霜、维护或清洁时，可能会导致冷冻食品温度升高，从而缩短其储存期限。

解冻

根据可用的时间，深度冷冻或冰冻的食物在食用前，可选择在冷藏室或室温下解冻。

对于小块的食物，甚至可以直接从冷冻食品室里取出后进行烹饪：在这种情况下，烹饪的时间会相应延长。

- ⚠ **警告！** 如果发生意外解冻情况（例如，停电时间超过了冰箱铭牌上标注的负载回升时间），已经解冻的食物应当尽快食用，或者立即烹饪后再进行冷冻保存（注意是烹饪完后再冷冻）。

日常使用

要降低冰箱能耗，请遵循以下建议：

- 将冰箱安装在干燥、通风良好的房间，远离任何热源（如散热器、炉灶等），并避免阳光直射。如有需要，可使用隔热板。
- 为确保充分通风，请遵循安装说明。
- 冰箱后部通风不足会增加耗电量并降低冷却效率。
- 冰箱的内部温度可能受环境温度、开门频率以及冰箱摆放位置的影响。设定温度时应考虑这些因素。
- 请将温热的食物和饮料冷却至室温后再放入冰箱内。

- 请勿用食物遮挡住风扇（如果冰箱配备有风扇）。
- 在放置或取出食物后，请确保冰箱门，特别是冷冻室门已妥善关闭。
- 尽量减少开门次数。
- 解冻冷冻食品时，请将其置于冷藏室内。冷冻产品的低温可以帮助冷却冷藏室内的其他食物。
- 冰箱内搁架的位置对能效没有影响。食物应放置在搁架上，以确保空气能正常流通（食物之间以及食物与后壁之间应保持适当距离，避免相互接触）。
- 密封条若损坏，必须尽快更换。

清洁与维护

常规提示

- 请使用温水和中性洗涤剂专门调配的溶液，并搭配抹布，定期清洁冰箱内部。请勿使用磨蚀性清洁剂或工具。
- 使用配件包中提供的管道清洁剂定期清洁冷藏室后部的除霜水排水孔。这样可以确保除霜水顺畅排出，避免水溢出后滴到冰箱内的食物上。
- 在维修或清洁冰箱之前，请从电源插座上拔下插头或断开电源。

警示！ 冰箱配件不得放入洗碗机中。

冷藏室除霜

冰箱内部食物的水分蒸发或日常使用中外部空气的水分进入冷藏室，都可能导致冷藏室内结霜。遇到这种情况，您可以通过手动提高冰箱的温度设置来启动自动除霜功能。冷藏室内后壁出现水滴，即表示正在进行自动除霜过程。除霜水会自动流入排水口，随后流入集水容器并最终蒸发。

警示！ 冰箱配件不得放入洗碗机中。

冷冻室除霜

结冰是冷冻室内的正常现象。结冰的程度和速度受环境温度、湿度以及冰箱门开启频次的影响。

1. 在从冷冻室取出食物前，请先将冰箱调至最冷设置并保持四小时，以在除霜期间尽量延长食物的保鲜时间。

2. 随后，关闭冰箱电源，并取出抽屉。将冷冻食物放置在阴凉处。
3. 打开冷冻室门，让冰霜自然融化。为防止除霜水流到地板上，请在冷冻室底部铺上吸水布，并定期拧去积水。
4. 清洁冷冻室内部。仔细冲洗并擦干。
5. 重新接通电源，并将食物重新放入冷冻室中。

如果长时间不使用冰箱

1. 关闭冰箱。
2. 断开冰箱电源。
3. 移除内部所有食品。
4. 彻底除霜并清洁冰箱。
5. 略微打开冰箱门，确保内部空气流通。这有助于防止霉菌滋生和异味产生。

遇到停电情况

- 请保持冰箱门关闭，这将有助于食物尽可能长时间地保持低温状态。
- 如果食物已经部分解冻，请不要再将其重新冷冻，应在 24 小时内食用完毕。

更换照明灯

该冰箱配有内部照明灯。

只有售后服务人员可以更换照明装置。

请联系宜家。请访问 www.IKEA.com，并选择您所在的本地商店，以获取当地商店的联系电话和营业时间。

故障排除

问题	可能原因	解决方法
冰箱无法运行。	冰箱已关闭。	打开冰箱。
	电源插头没有正确连接到电源插座。	将电源插头正确连接到电源插座。
	电源插座中无电压。	要检查电源插座是否正常工作，可以尝试将其他电器插入该插座。联系具备资质的电工来修理插座。
冰箱有噪声。	冰箱放置不牢固。	调平冰箱。请参阅“调平冰箱”章节或《安装说明》。
照明灯不亮。	照明灯有缺陷。	请参阅“更换照明灯”章节。
压缩机持续运行。	设定的温度过低。	设定更高温度。请参阅“操作”章节。
	一次放入过多食物。	等待数小时后再次检查温度。
	室温过高。	如果条件允许，请重新调整冰箱的位置。请参阅“选位”章节。
	冰箱内存放的食物过热。	将食物冷却至室温后再储存。
	冰箱门未关紧。	请参阅“关闭冰箱门”章节。
冰箱内的温度过低或过高。	温度设置不正确。	设定更高或更低的温度。
	冰箱门未关紧。	请参阅“关闭冰箱门”章节。
	冰箱内存放的食物过热。	将食物冷却至室温后再储存。
	一次放入过多食物。	应少量放入食物。
	冷冻室冰霜厚度大于 4-5 mm。	给冷冻室除霜。请参阅“冷冻室除霜”章节。
	冰箱门频繁开关。	只在必要时开关冰箱门。
	冰箱内无足够冷气循环。	重新摆放食物，确保冰箱内的空气可以自由流通。
冰箱内后壁有过多冷凝水。	冰箱门频繁开关。	只在必要时开关冰箱门。
	冰箱门未关紧。	确保关紧冰箱门。请参阅“关闭冰箱门”章节。
	食物未包裹。	把食物放进冰箱之前，先用适当的包装包好。
水在冰箱内流动。	冰箱后的排水孔堵塞。	使用随附的工具清洁排水孔。
	食物阻止水流入集水装置。	确保食物不接触内后壁。
水流到了地上。	冰箱门未关紧。	请参阅“关闭冰箱门”章节。
	冰箱向前倾斜。	将冰箱稍微向后倾斜（在背面向下 6 mm）。更多详细信息请参阅《安装说明》。
	滴水盘破裂。	请联系本手册末尾所列的授权服务中心。
	冰箱后的排水孔堵塞。	使用随附的工具清洁排水孔。
冰箱门未关紧。	请参阅“关闭冰箱门”章节。	请参阅“关闭冰箱门”章节。

正常噪音

制冷系统发出一些诸如咕噜声和嘶嘶声等噪音，这是正常现象。

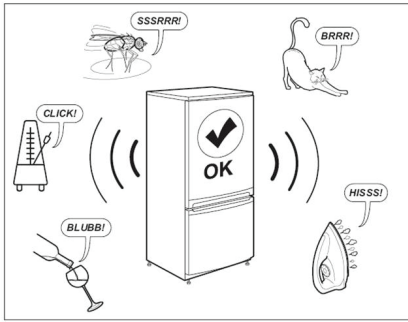

关闭冰箱门

如果	操作
门封条脏了。	请进行清洁。
门封条损坏。	请联系售后服务进行更换。
门被架子、抽屉、食品等阻挡。	请正确放置或移除阻挡门的物品。
冰箱未调平。	调平冰箱。请参阅“调平冰箱”章节或《安装说明》。
门与冰箱柜体未对齐。	请调整门。请参阅《安装说明》。

联系售后服务之前：

请重新启动冰箱，查看故障是否已修复。如果故障仍然存在，请再次关闭冰箱，并在一小时后重复此操作。

如果在按照故障排除指南进行检查并重新开启冰箱后，您的冰箱仍然无法正常运行，请联系售后服务，并清晰地描述问题，同时提供以下信息：

- 问题的性质
- 购买日期
- 冰箱的型号和序列号

i 产品编号和序列号位于冰箱内部左侧的铭牌上。

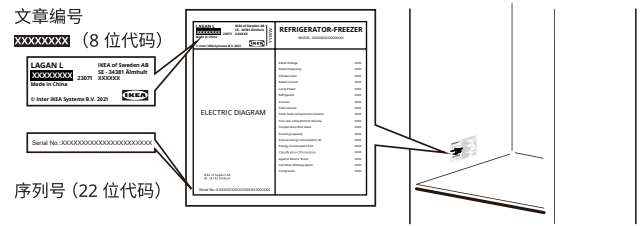
**技术规格**

产品类别	
产品类型	冷藏室 - 冷冻室
安装类型	驻立式
产品尺寸	
高度	1773 mm
宽度	547 mm
深度	568 mm
净容积	
冷藏室	197 L
冷冻室	65 L 
除霜系统	
冷藏室	手动
冷冻室	手动
其他规格	
负载回升时间	10 h
冷却能力	10 kg/12 h
冷冻能力	1.5 kg/12 h
耗电量	标准耗电量：0.590 kW·h/24 h, 215 kW·h/a 综合耗电量：0.690 kW·h/24 h, 252 kW·h/a
噪音水平	38 dB(A)
能效等级	3 级
额定电压	220 V~
额定频率	50 Hz
所用标准	GB4706.1 GB4706.13 GB4343.1 GB17625.1 GB19606 GB12021.2 GB/T8059

食品接触清单

提示

食品接触清单中零部件包含不同产品型号的部件，具体以实物为准。

食品接触材料列表		
零部件名称	部件材质	执行标准
内胆	PS/ 铝板 /PCM/ABS	GB4806.1/GB4806.7/GB4806.9
抽屉	PS/PP/ABS	GB4806.1/GB4806.7
口框	ABS/PS	GB4806.1/GB4806.7
果菜盒、瓶框、蛋架、灯罩等	PS/ABS	GB4806.1/GB4806.7
搁物架总成	玻璃 /PS/PP/ABS/ 钢丝 + 环氧树脂等	GB4806.1/GB4806.5/GB4806.7/ GB4806.9/GB4806.10
制冰机及水路管件	POM/PP/ABS/PS/ 不锈钢 / 铝管 / 硅橡胶等	GB4806.1/GB4806.7/GB4806.9/ GB4806.11
风道组件	PP/PS/ 铝合金 / 冷轧钢板	GB4806.1/GB4806.7/GB4806.9
面光源组件	PMMA 等	GB4806.1/GB4806.7
保鲜组件	ABS	GB4806.1/GB4806.7
温控盒、旋钮、盒盖等	阻燃 PS/PS/ABS	GB4806.1/GB4806.7
接水盘、装饰条、栏条、孔塞等	ABS/PP/ 镀铬 + 钢丝	GB4806.1/GB4806.7/GB4806.9
丝管蒸发器、吹胀蒸发器等	冷轧钢板 + 环氧树脂 / 铜管 / 铝管等	GB4806.1/GB4806.9/GB4806.10

备注：明细表中的部件为不同型号产品所包含的主要部件汇总，具体产品部件，以实际产品配置为主。

产品中的有害物质

产品中有害物质的名称及含有的信息表

部件名称	有害物质									
	铅 (Pb)	汞 (Hg)	镉 (Cd)	六价铬 (Cr (VI))	多溴联苯 (PBBs)	多溴二苯醚 (PBDEs)	邻苯二甲酸二正丁酯 (DBP)	邻苯二甲酸二异丁酯 (DIBP)	邻苯二甲酸丁苄酯 (BBP)	邻苯二甲酸二(2-乙基)己酯 (DEHP)
箱体及其组件	○	○	○	○	○	○	○	○	○	○
门体及其组件	○	○	○	○	○	○	○	○	○	○
压缩机组件及配件	×	○	○	○	○	○	○	○	○	○
PCB 板	×	○	○	○	○	○	○	○	○	○
制冷管路件	○	○	○	○	○	○	○	○	○	○
制冷剂	○	○	○	○	○	○	○	○	○	○
电器元器件	×	○	○	○	○	○	○	○	○	○
包装印刷组件	○	○	○	○	○	○	○	○	○	○
辅料	○	○	○	○	○	○	○	○	○	○

注 1:
 ○: 表示该有害物质在该部件所有均质材料中的含量均不超出电器电子产品有害物质限制使用国家标准要求。
 ×: 表示该有害物质至少在该部件的某一均质材料中的含量超出电器电子产品有害物质限制使用国家标准要求。

注 2: 以上未列出的部件, 表明其有害物质含量均不超出电器电子产品有害物质限制使用国家标准要求。

环保要求

请回收带有 ♻️ 标志的材料。

请将包装材料放入相应的回收容器中。请回收废旧的电气电子设备, 保护环境和人类健康。请勿将本产品与普通生活垃圾一同丢弃。请将产品送往当地回收机构, 或联系市政部门获取处理指引。



宜家质保

宜家产品的质保期有多长？

自原始购买之日起，宜家电器享有**五 (5) 年质保服务**。需提供原始销售收据作为购买凭证。如果质保期内出现售后服务，售后服务不会延长产品的质保期限。

哪些 LAGAN 电器不享受宜家的 5 年质保？

对于 2026 年 5 月 1 日之前从宜家购买的 LAGAN 电器，自原始购买之日起，质保期为两 (2) 年。

由谁提供售后服务？

宜家服务提供商将通过其自身的服务运营或由其授权的服务合作伙伴提供服务。

产品质保涵盖哪些内容？

质保范围包括从宜家购买之日起，因制造缺陷或材料不良导致的设备故障。本质保仅对家用生效。例外情况已在标题“产品质保不涵盖哪些内容？”下具体说明。质保期内的维修成本，例如修理、配件、人工和差旅费无需用户承担，前提是维修设备时不产生特别支出。在此条件下，适用于各地地方性法规。更换下来的部件将归宜家所有。

宜家将如何纠正问题？

宜家指定的服务提供商将对产品进行检查，并自行决定产品是否在质保范围内。若被视为在质保范围内，宜家服务提供商或由其授权的服务合作伙伴将通过其自身的服务运营，自行决定维修有缺陷的产品或将其更换为相同或同等的产品。

产品质保不涵盖哪些内容？

- 正常磨损。
- 故意或疏忽造成的损坏；不遵守操作说明、不正确安装或连接错误电压造成的损坏；化学或电化学反应、生锈、腐蚀或水渍造成的损坏，包括但不限于由供水中的过量石灰造成的损坏；异常环境条件造成的损坏。
- 耗材包括电池和灯。
- 不影响设备正常使用的非功能性和装饰性部件，包括各种划痕和色差。
- 外物以及清洗或疏通过滤器、排水系统或肥皂盒导致的意外损坏。
- 以下部件的损坏：陶瓷玻璃、配件、餐具篮、进水和排水管、密封件、灯和灯盖、屏幕、旋钮、外壳和外壳部件。除非这些损坏能被证明是由生产故障造成的。
- 在技术人员检查期间未发现故障的情况。
- 维修工作并非由我们的指定服务提供商和 / 或授权服务合作伙伴执行，或未使用原厂配件。
- 因错误安装或未按照规范安装而导致的维修。
- 在非家庭环境中使用该设备，即用于专业用途。
- 运输过程中损坏。如果客户将产品运送至自己家中或其他地址，宜家对运输中可能产生的任何损坏概不负责。但是，如果宜家将产品运送到客户指定的送货地址，那么运输途中发生的产品损坏由宜家承担。
- 宜家设备的初装费用。
- 但是，如果宜家指定的服务提供商或其授权服务合作伙伴依照本质保条款维修或更换设备，如有必要，指定的服务提供商或其授权服务合作伙伴将重新安装修复后的设备或安装替换设备。
- 宜家不承担水管和电气安装，客户须在安装设备之前完成此工作。

国家 / 地区法律如何适用

宜家保修条款赋予您明确的法律权力，涵盖或超出了当地所有的法定要求。然而，这些条件并不以任何方式限制当地法律所规定的消费者权利。

有效区域

本保修条款仅在购买产品的国家 / 地区有效；服务将在质保条件的框架内提供。只有在设备符合并按照以下规定安装的情况下，宜家才有义务在此质保框架内提供维修服务：

- 提出保修申请时所在国家的技术规格；
- 《安装说明》和《用户手册》中的《安全信息》；

宜家电器的专用售后服务

请随时联系宜家指定的授权服务中心以便：

- 依据本质保条款提出服务请求；
- 咨询如何在宜家专用厨房家具中安装宜家电器；
- 就宜家电器的功能进行咨询。

为确保我们能够为您提供最佳协助，请在联系我们之前仔细阅读《安装说明》和 / 或《用户手册》。

联系宜家售后客服



当您拨打服务电话时，宜家售后客服中心会在电话中协助您解决设备的基本问题。

请访问

www.IKEA.com

并选择您所在的本地商店，以获取当地商店的联系电话和营业时间。

在致电我们之前，请确保您能提供需要售后服务的宜家设备的产品编号 (8 位代码) 和序列号 (22 位代码，可在铭牌上找到)。

- ① 请保留销售收据！收据是您的购买凭证，也是获得质保的必要条件。请注意，收据还会注明您所购买的每件电器的宜家产品名称和编号 (8 位代码)。

您需要进一步的帮助吗？

如有任何与电器售后无关的其他问题，请联系离您最近的宜家商场客服中心。建议您在联系我们之前先仔细阅读说明书。

